



CITY OF NEWPORT BEACH
 3300 Newport Boulevard
 P.O. Box 1768
 Newport Beach, CA 92658-8915
 (949) 644-3200

NOTICE OF EXEMPTION

To: <input type="checkbox"/> Office of Planning and Research P.O. BOX 3044 Sacramento, CA 95812-3044		From: City of Newport Beach Planning Department 100 Civic Center Drive, P.O. Box 1768 Newport Beach, CA 92658-8915	
<input type="checkbox"/> County Clerk, County of Orange Public Services Division Santa Ana, CA 92702		Date received for filing at OPR/County Clerk:	
Project Title:	Macy's Sign Modification (PA2013-207) Modification Permit No. MD2013-020		
Project Location – Specific	The project is located at 101 Newport Center Drive within the Fashion Island Regional Shopping Center in the North Newport Center Planned Community. Fashion Island is shown on Exhibit 1, North Newport Center Planned Community, attached hereto.		
Project Location - City:	Newport Beach	Project Location – County	Orange
Project Description:	<p>On December 23, 2013, the Zoning Administrator approved a modification permit to allow the construction of two major tenant signs to existing wall signage for a total of four wall signs for Macy's within Fashion Island. The locations of the existing and proposed signs are shown on Exhibit 2 attached hereto. The proposed signs measure 6'-9 3/4" inches in height for the south elevation and 6'-0 3/4" in height for the east elevation. The proposed signs are shown on Exhibits 3 and 4, attached hereto.</p> <p>Also on December 23, 2013, the Zoning Administrator determined that the project is exempt from further environmental review consistent with the California Environmental Quality Act (CEQA) Guidelines under section 15311, Class 11 (Accessory Structures) that exempts construction or placement of minor structures accessory to (appurtenant to) existing commercial, industrial or institutional facilities, including but not limited to on-premise signs. (California Code of Regulations, Title 14, Chapter 3, Article 19, Section 15311).</p>		

POSTED

JAN 02 2014

HUGH NGUYEN, CLERK-RECORDER

BY: DA DEPUTY

FILED

JAN 02 2014

HUGH NGUYEN, CLERK-RECORDER

BY: DA DEPUTY

Recorded in Official Records, Orange County
 Hugh Nguyen, Clerk-Recorder



50.00

1 * \$ R 0 0 0 6 4 2 0 7 5 2 \$ *
 201485000001 10:44 am 01/02/14
 46 SC1 Z01
 0.00 50.00 0.00 0.00 0.00 0.00 0.00 0.00

POSTED

JAN 02 2014

HUGH NGUYEN, CLERK-RECORDER

BY: HA DEPUTY

Exempt Status: (check one)

- Ministerial (Sec. 21080(b)(1);15268);
- Declared Emergency (Sec. 21080(b)(3); 15269(a));
- Emergency Project (Sec. 21080(b)(4); 15269(b)(c));
- Categorical Exemption. State type and section number: Class 11-Accessory Structures (§15311)
- Statutory Exemptions. State code number _____
- General Rule (Sec. 15061(b)(3))

Reasons why project is exempt: The City considered any potential environmental effects of the proposed project. Based on the Zoning Administrator review and all supporting materials provided, the Zoning Administrator determined that the project is exempt from further environmental review consistent with the Class 11 – Accessory Structures exemption under CEQA Guidelines section 15311. Class 11 consists of construction or replacement of minor structures accessory to (appurtenant to) existing commercial, industrial or institutional facilities including on-premise signs. The additional signs are accessory to the primary use of the site which is designated as Regional Commercial in the Land Use Element of the City's General Plan. The addition of the signs is consistent with Class 11 construction and replacement of minor structures. The addition of the signs will, therefore, have no significant environmental impact. The Zoning Administrator found the following to determine that the project is exempt from further CEQA review:

1. The modification permit is consistent with the legislative intent of Title 20, Chapter 20.52 of the Newport Beach Municipal Code with regard to modification permit regulations.
2. The granting of the permit will not adversely affect the health or safety of persons residing or working in the neighborhood of the property and will not be detrimental to the general welfare or injurious to property or improvements in the neighborhood.

Project Applicant: Irvine Company
Applicant Contact: John Murphy
Applicant Address: 101 Innovation
 Irvine, CA 92617-3040
 (949) 720-3171

FILED

JAN 02 2014

HUGH NGUYEN, CLERK-RECORDER

BY: HA DEPUTY

Name of Public Agency Approving Project: City of Newport Beach

Date of Approval: December 23, 2013

Name of Person or Agency Carrying Out Project: City of Newport Beach

Contact Person: Makana Nova **Title:** Assistant Planner **Tel. No.:** (949) 644-3249

Signature: 

Date: 12/23/2013

POSTED

FILED

JAN 02 2014

JAN 02 2014

HUGH NGUYEN, CLERK-RECORDER

HUGH NGUYEN, CLERK-RECORDER

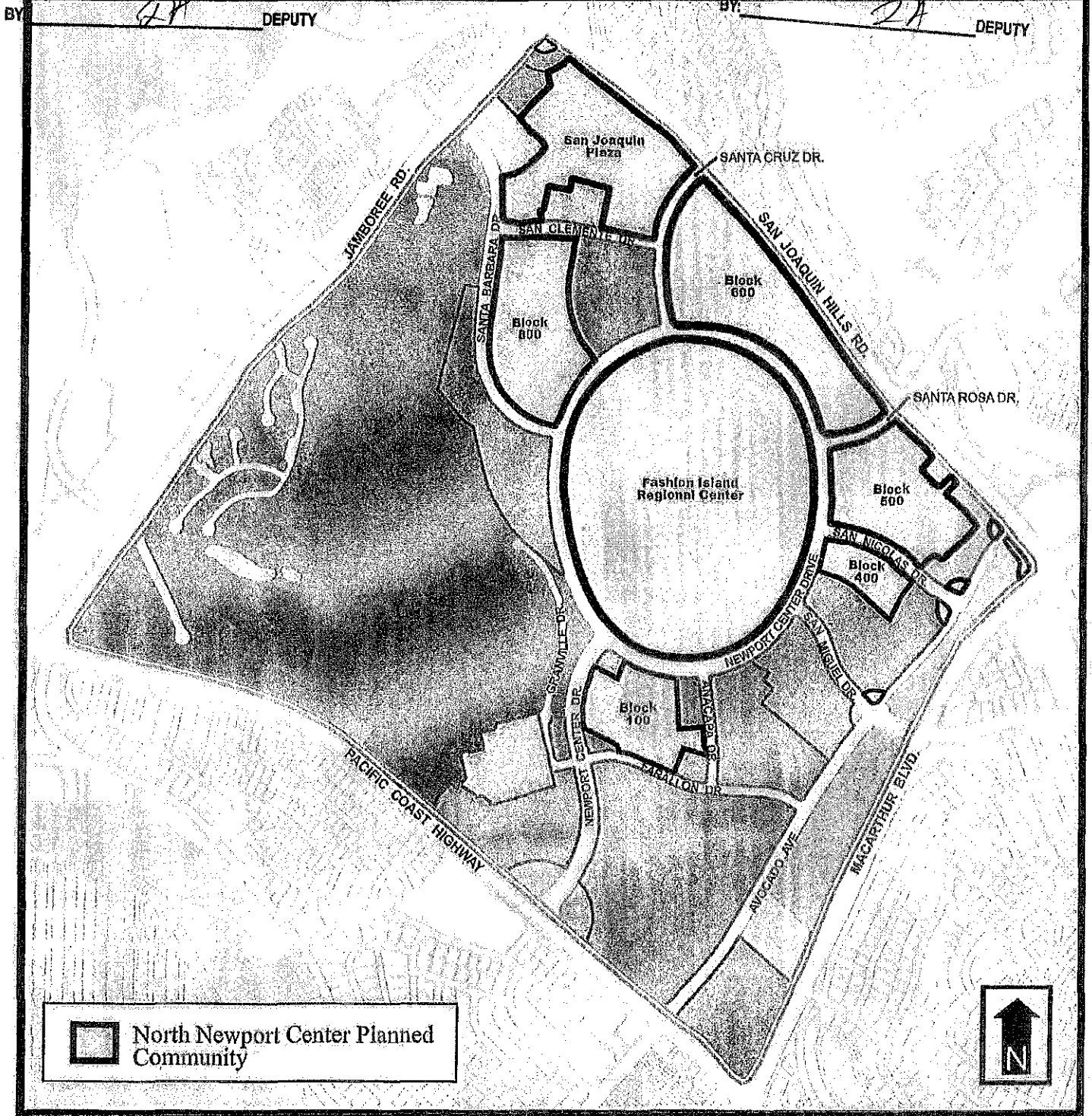

Exhibit 1 - North Newport Center Planned Community



SOUTH ELEVATION
NEW 4'-0" LETTERS
AT ENTRY
(SEE PG. 3)

EXISTING 6'-0" SET OF
LETTERS TO REMAIN

EXISTING 6'-0" SET OF
LETTERS TO REMAIN

EAST ELEVATION
NEW 3'-4" LETTERS
AT ENTRY
(SEE PG. 4)



BRITELITENEON
corporation

5514 SATSUMA AVENUE
NORTH HOLLYWOOD, CA 91601
PHONE: 818.763.4798
FAX: 818.763.5758

JOB NAME: ★macy's	DATE: 4-15-13	DRAWING #: 2 OF 6
ADDRESS: FASHION ISLAND NEWPORT BEACH, CA	DRAWN BY: AK	APPROVED BY:
	REVISED: 12-16-13	

Exhibit 2 - Existing & Proposed Signs

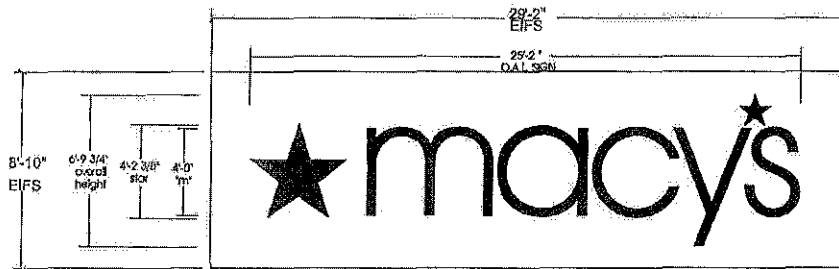

LAYOUT OF SIGN ON NEW EIFS BACKGROUND
TYPICAL FOR ALL 4 ENTRIES

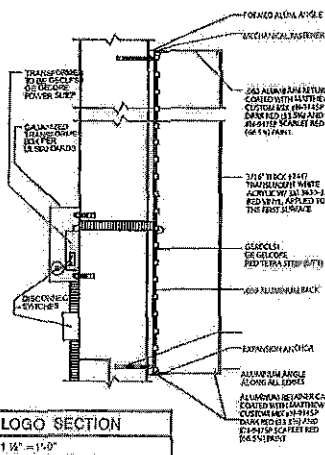

8 STAR LOGO SECTION
SCALE: 1/4" = 1'-0"

STAR LOGO
 2" DEEP INDICATED ON ALL VERTICAL SECTIONS WELDED TO THE ALUMINA ANGLE.
 ALL EXPOSED ALUMINA ANGLE TO BE COATED WITH MATTHEWS CUSTOM BAK ENAMEL APPLIED TO THE INSIDE AND INSIDE SCARFED TO 45° ANGLE.
 TRANSLUCENT WHITE ALUMINA ANGLE FRAMING APPLIED TO THE FRONT SURFACE.
 LOGO TO HAVE FINISHED ALUMINA ANGLE FRAMING APPLIED TO THE FRONT SURFACE.
 ILLUMINATION PROVIDED BY GAL-CONE LED LIGHT FIXTURES POWERED BY QUANTE POWER SUPPLY.
 LOGO MOUNTED TO WALL SURFACE USING FORMED ANGLE ANCHORS AND STAINLESS MECHANICAL FASTENERS.

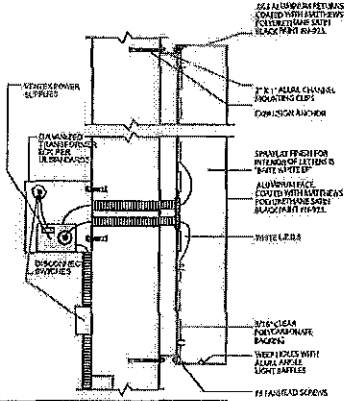

8A LETTER SECTION
SCALE: 1/4" = 1'-0"

FRONT VIEW
SCALE: 1/4" = 1'-0"

LETTERSET
 1/2" DEEP INDICATED ON ALL VERTICAL SECTIONS WELDED TO THE ALUMINA ANGLE.
 ALL EXPOSED ALUMINA ANGLE TO BE COATED WITH MATTHEWS CUSTOM BAK ENAMEL APPLIED TO THE INSIDE AND INSIDE SCARFED TO 45° ANGLE.
 LETTERS TO HAVE 3/16" THICK CLEAR POLYCARBONATE MECHANICALLY FASTENED TO RETURN.
 LETTERS TO BE 3/16" THICK CLEAR POLYCARBONATE MECHANICALLY FASTENED TO RETURN.

BRITELITENEON
corporation

5514 SATSIMA AVENUE
NORTH HOLLYWOOD, CA 91601
PHONE 818.763.4798
FAX 818.763.5768

JOB NAME:	DATE: 4-15-13	DATE: DRAWING # 5 OF 6
ADDRESS: FASHION ISLAND NEWPORT BEACH, CA	DRAWN BY: AK	APPROVED BY:
	REVISED: 12-16-13	



Hugh Nguyen
Clerk - Recorder

RECEIVED BY
COMMUNITY

FEB 10 2014

Orange County
Clerk-Recorder's Office
12 Civic Center Plaza, Room 106, P.O. Box 238, Santa Ana, CA 92702
web: www.oc.ca.gov/recorder/
PHONE (714) 834-2500 FAX (714) 834-5284

DEVELOPMENT
CITY OF NEWPORT BEACH

CITY OF NEWPORT BEACH
100 CIVIC CENTER DRIVE PO BOX 1768
NEWPORT BEACH, CA 92685

Office of the Orange County Clerk-Recorder
Memorandum

SUBJECT: NOTICE OF EXEMPTION

The attached notice was received, filed and a copy was posted on 01/02/2014

It remained posted for 30 (thirty) days.

Hugh Nguyen
Clerk - Recorder
In and for the County of Orange

By: AGUIRRE, IDALIA

Deputy

Public Resource Code 21092.3

The notice required pursuant to Sections 21080.4 and 21092 for an environmental impact report shall be posted in the office of the County Clerk of each county *** in which the project will be located and shall remain posted for a period of 30 days. The notice required pursuant to Section 21092 for a negative declaration shall be so posted for a period of 20 days, unless otherwise required by law to be posted for 30 days. The County Clerk shall post notices within 24 hours of receipt.

Public Resource Code 21152

All notices filed pursuant to this section shall be available for public inspection, and shall be posted *** **within 24 hours of receipt** in the office of the County Clerk. Each notice shall remain posted for a period of 30 days.

*** Thereafter, the clerk shall return the notice to the local **lead** agency *** within a notation of the period it was posted. The local **lead** agency shall retain the notice for not less than nine months.

Additions or changes by underline; deletions by ***